

8 7 6 5 4 3 2 1

TECHNICAL SPECIFICATIONS	
24050	2ML VIAL CAPACITY
13	DRAWERS PER TOWER
110 / 230v AC	POWER
3/8 BSP 24V DC	SOLENOID VALVE 1
3/8 BSP 24V DC	SOLENOID VALVE 2
3/8" BSP BALL VALVE	MANUAL FILL BYPASS
DISCRETE SENSORS	LEVEL PROBE
PT1000	TEMPERATURE SENSOR
Ø982 MM	EXTERNAL WIDTH
1550 MM	EXTERNAL DEPTH
1952 MM	EXTERNAL DEPTH WITH LID OPEN
1249 MM	EXTERNAL HEIGHT
1444 MM	EXTERNAL HEIGHT INC CONTROLLER
2143 MM 2292 MM LID @ 90°	EXTERNAL HEIGHT WITH LID OPEN
LESS THAN 2143 MM	MIN ROD CEILING HEIGHT (TO CLEAR TOWER)
786 MM	USABLE INTERNAL DIAMETER
765MM	USABLE INTERNAL HEIGHT
90 LITRES	LN2 CAPACITY
1/2" BSPT	LN2 INLET CONNECTIONS ON VESSEL
1.5 +/- 0.5 BAR (22+7 PSI)	LN2 SUPPLY PRESSURE
4.5 BAR / (66PSI)	PRESSURE RELIEF VALVE SETTING
24050	2ML VIAL CAPACITY (SQUARE RACKS)
13	ROWS PER TOWER
17	NUMBER OF 10 X 10 TOWERS
6	NUMBER OF 5 X 5 TOWERS

1. QUOTED LN2 CAPACITY REFERS TO FULL VOLUME OF LN2 SPACE. TO MAINTAIN TEMPERATURE STABILITY IT IS RECOMMEND UNIT IS REFILLED BEFORE REACHING EMPTY.
2. IDEAL CONDITIONS  
15-25°C  
<60%RH  
MAXIMUM SAMPLE LOAD.
3. FOR DETAILS OF ALTERNATIVE ICS PLEASE CONTACT QUANTUM CRYOGENICS.
4. TWIN FAIL CLOSED SOLENOID'S.
5. ENSURE FILTER IS USED TO PROTECT SOLENOID VALVES.
6. WHEN CONNECTED TO A PIPE SUPPLY ENSURE SUPPLY PRESSURE IS REGULATED TO < 2BAR (30 PSI)
7. GAS VENT / PRECOOL / HOT GAS BYPASS SYSTEM MAY BE REQUIRED. CONTACT QUANTUM CRYOGENICS FOR MORE INFORMATION.
8. STANDARD SUPPLY HOSE DN 12 STAINLESS STEEL 1.5 METRES LONG ½" BSPT MAIL TO 15MM BULLNOSE 69GHD BOTH ENDS. NITRILE RUBBER FOAM INSULATION WITH PVC WRAP. ALTERNATIVE LENGTH / CONNECTIONS AVAILABLE UPON REQUEST.
9. FOR DETAILS OF DATA LOGGING / REMOTE MONITORING / CONTROL OPTIONS PLEASE CONTACT QUANTUM CRYOGENICS.
10. ENSURE APPROPRIATE VENTILATION AND OXYGEN DEPLETION MONITORING ARE IN PLACE.

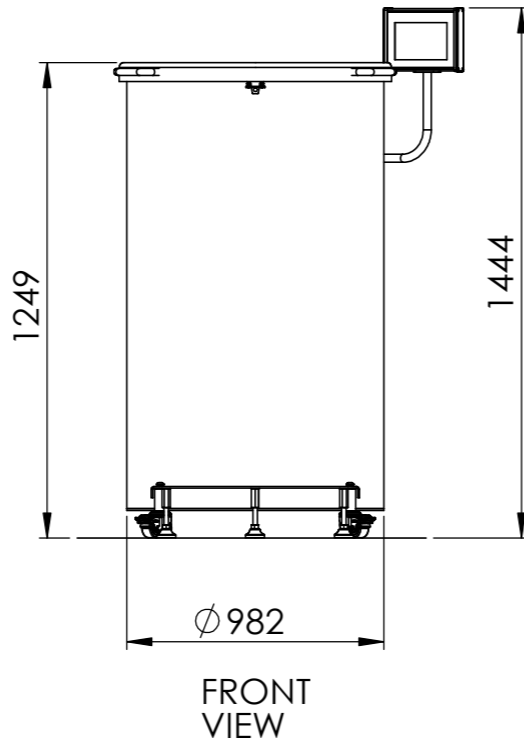
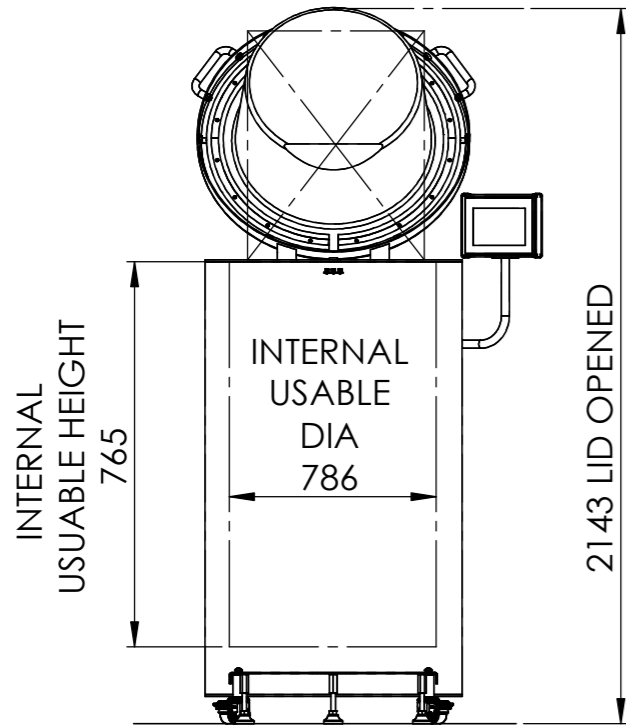
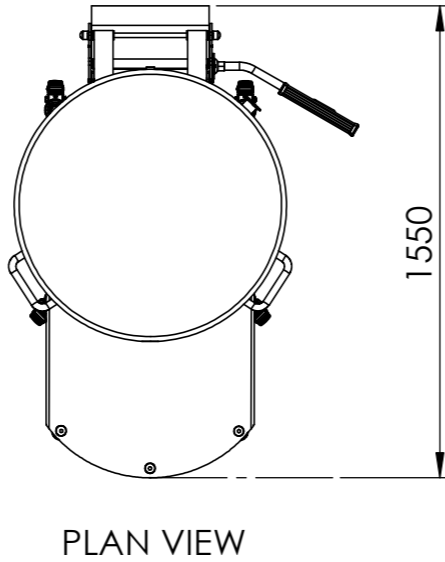
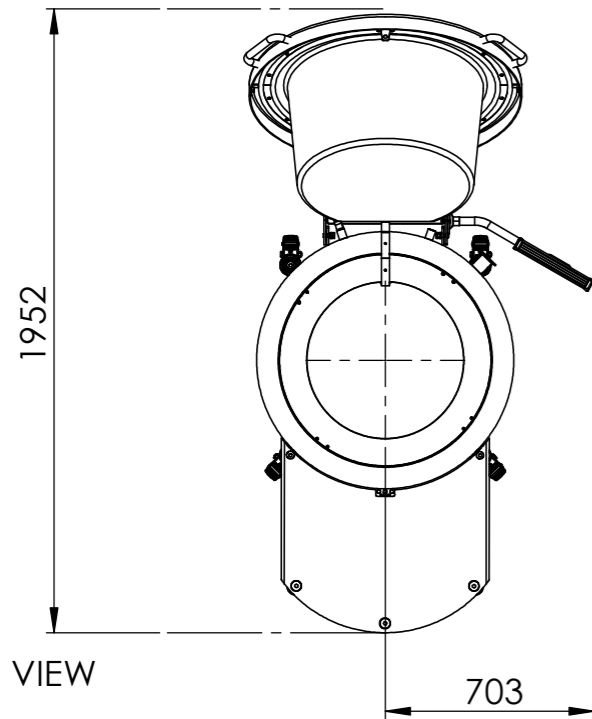

UNLESS OTHERWISE SPECIFIED: DIMENSIONS ARE IN MILLIMETERS SURFACE FINISH: TOLERANCES: LINEAR: +/- 0.5mm ANGULAR: 0.5 Deg		FINISH: Paint White As Per Note		DEBURR AND BREAK SHARP EDGES	
DRAWN	NAME	SIGNATURE	DATE		
CHK'D	S.McI.		09.09.22		
APPV'D					
MFG					
Q.A				MATERIAL:	NA
				WEIGHT Approx. (g)	

DO NOT SCALE DRAWING

REVISION: 0

Head Office, Unit B Cranmere Court,  
Exeter Road Industrial Estate, Okehampton,  
Tel: +44 (0) 1844 339993, www.quantumcryogenics.com

TITLE:  
**POLARIS VECTOR 23  
SPECIFICATION**

DWG NO. **A-1238**

A3

SCALE:1:20

SHEET 1 OF 1

8 7 6 5 4 3 2 1